

## Typical HD Configuration (including flush walkable panels)

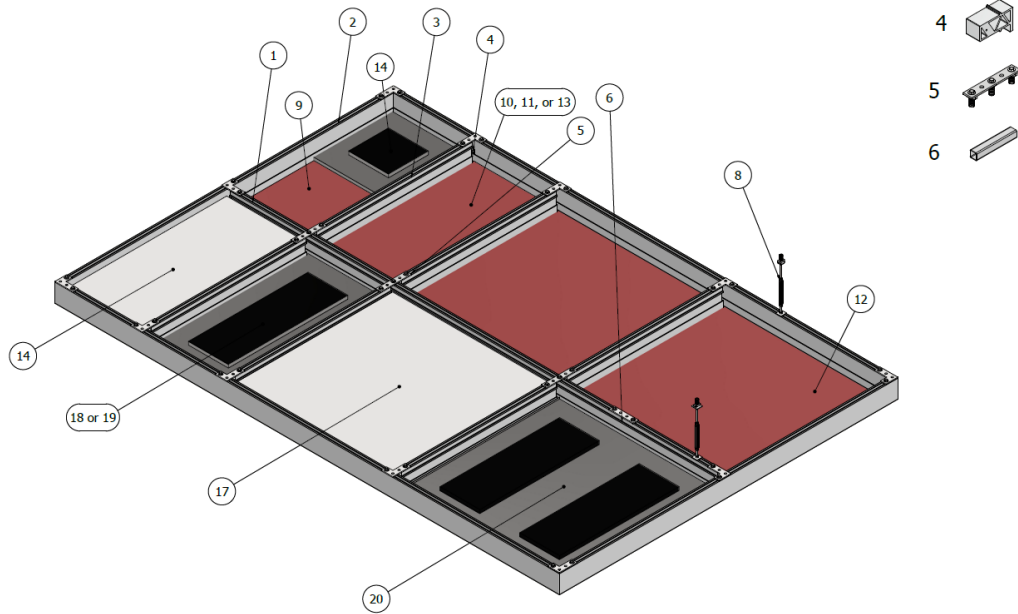

### Parts List

#	Part Number	Description
1	IG-M-20	Intelligrid Main (20ft)
2	IG-WM-20	Intelligrid Wall Main (20ft)
3	IG-HDC	Intelligrid Heavy Duty Cross Tee (46.75in)
4	IG-HBK	Hanger Block – Cross to Main
5	IG-MTM-S5	5 Hole Splice Plate- Main to Main Straight
6	IG-MTM-A	Alignment block for main-to-main connections, 1in x 1in Aluminum Tube
7	IG-MTM-C	Splice Plate – Cross tee to Main
8	AHA-3/8-IG-PP	Hanging Hardware (all 3/8-16) – (2x) Spring Nut, (2x) 1in Square Washer, (2x) Flat Washer, (2x) Hex Nut, (1x) LH/RH Threaded Stud (6in length), Threaded Rod, (1x) Turnbuckle
9	Spring Nut	Spring loaded strut nut (3/8-16)
10	IG-BP-22	Blank Panel 2ft x 2ft
11	IG-BP-24	Blank Panel 2ft x 4ft
12	IG-BP-44	Blank Panel 4ft x 4ft
13	IG-MP-24	Melt-Away Panel 2ft x 4ft
14	IG-LBP-24	2ft x 4ft – 2in thick SIPS panel - double sided aluminum with foam
15	IG-LBP-44	4ft x 4ft – 2in thick SIPS panel - double sided aluminum with foam
16	IG-FWP-24	2ft x 4ft - Diamond plate aluminum panel for flush walkable
17	IG-FWP-44	4ft x 4ft - Diamond plate aluminum panel for flush walkable
18	IG-LED-22	LED Flat Panel 2ft x 2ft
19	IG-LED-24	LED Flat Panel 2ft x 4ft
20	IG-LED-24BU	LED Flat Panel 2ft x 4ft with backup battery

## Typical LD Configuration

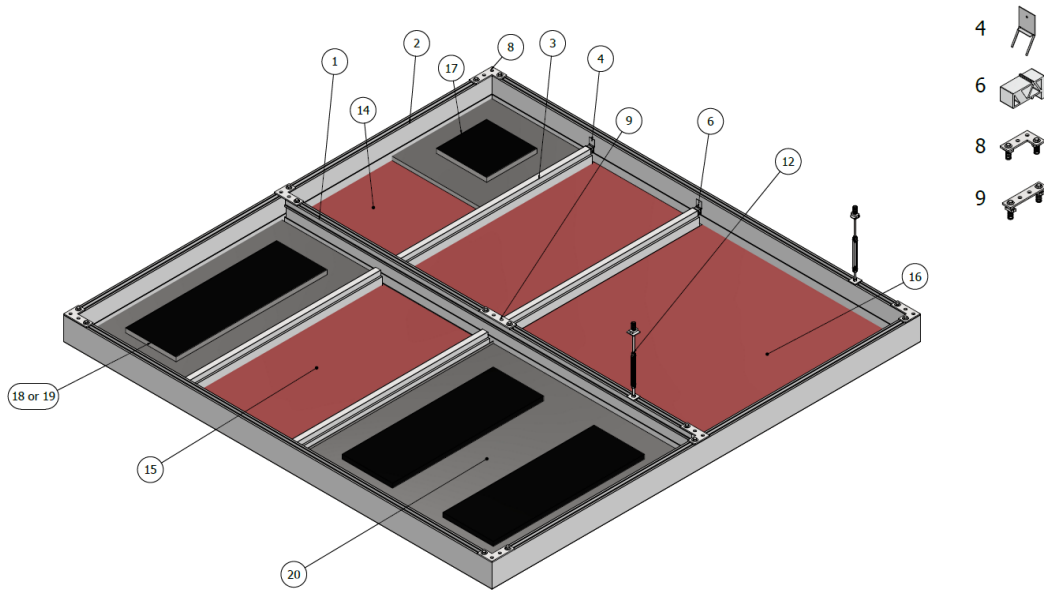

## Parts List

#	Part Number	Description
1.	IG-M-20	Intelligrid Main (20ft)
2.	IG-WM-20	Intelligrid Wall Main (20ft)
3.	IG-LDC	Intelligrid Light Duty Cross Tee (46.75in)
4.	IG-HDC	Intelligrid Heavy Duty Cross Tee (46.75in)
5.	IG-WCA	Intelligrid Wall to Ceiling Adapter
6.	IG-HBK	Hanger Block – Cross to Main
7.	IG-LDC-Clip	Intelligrid Light Duty Cross Tee Clip
8.	IG-MTM-C	Splice Plate – Wall Main to Wall Main/Main Right Angle
9.	IG-MTM-S4	4 Hole Splice Plate- Main to Main Straight
10.	IG-MTM-S3	3 Hole Splice Plate- Cross Tee Alignment Connections
11.	IG-MTM-A	Alignment Block for Main-to-Main Connections, 1in x 1in Aluminum Tube
12.	AHA-3/8-IG-PP	Hanging Hardware (all 3/8-16) – (2x) Spring Nut, (2x) 1in Square Washer, (2x) Flat Washer, (2x) Hex Nut, (1x) LH/RH Threaded Stud (6in length), Threaded Rod, (1x) Turnbuckle
13.	Spring Nut	Spring loaded strut nut (3/8-16)
14.	IG-BP-22	Blank Panel 2ft x 2ft
15.	IG-BP-24	Blank Panel 2ft x 4ft
16.	IG-BP-44	Blank Panel 4ft x 4ft
17.	IG-LED-22	LED Flat Panel 2ft x 2ft
18.	IG-LED-24	LED Flat Panel 2ft x 4ft
19.	IG-LED-24BU	LED Flat Panel 2ft x 4ft with backup battery
20.	IG-LED-44	(2x) LED Flat Panel 2ft x 4ft with IG-LSC (Grid Adapter)

IG-M

---

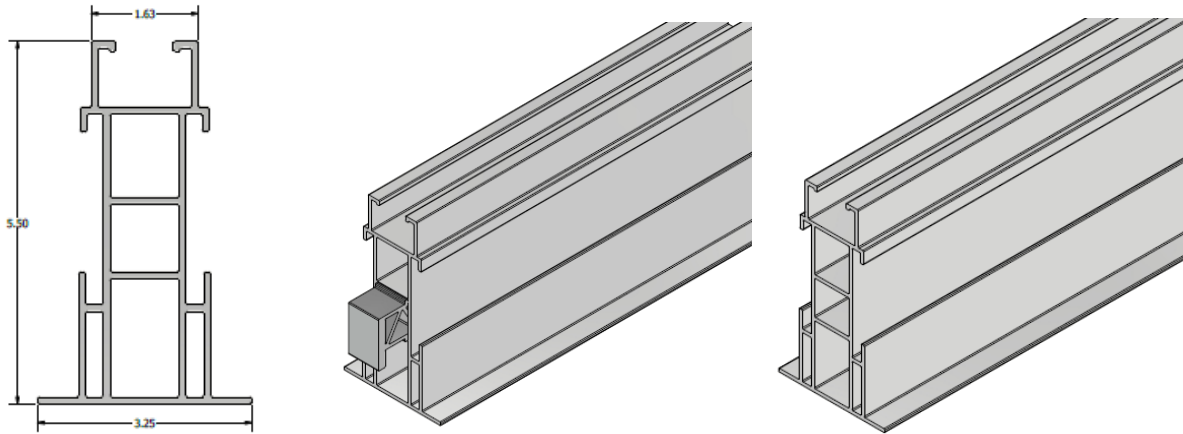

---

**Material:** Aluminum 6005A-T61

**Finish**

- Powder Coated Finish (RAL 9006 White)

**Specifications**

- Height: 5.50 inch
- Width: 3.25 inch
- Length: 240 inch (Customer Length Available)
- Weight: 0.226 lbs/in

**Features**

- 20ft hanger spacing (<10lbs/sqft)
- 10ft Hanger spacing (10-50lbs/sqft)
- 2 channels for supply of electrical/process utility

**IG-WM**

---

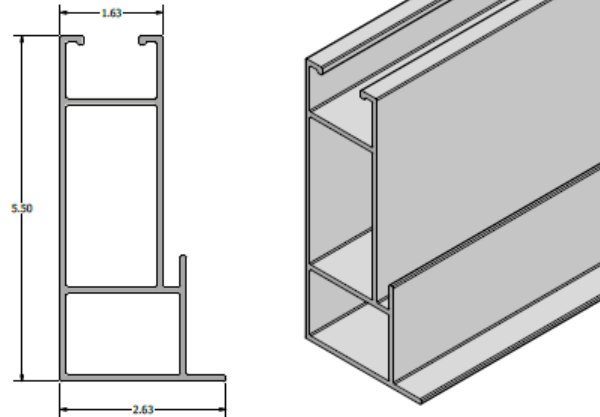

---

**Material:** Aluminum 6005A-T61

**Finish**

- Powder Coated Finish (RAL 9006 White)

**Specifications**

- Height: 5.50 inch
- Width: 2.63 inch
- Length: 240 inch
- Weight: 0.178 lbs/in

**Feature**

- Flush Mount on Wall
- 2 channels for supply of electrical/process utility

IG-LDC

---

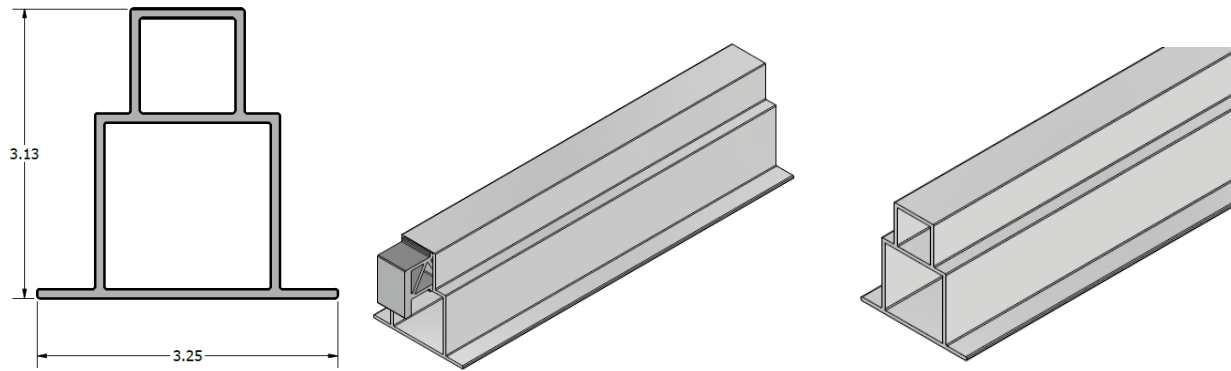

---

**Material:** Aluminum 6005A-T61

**Finish**

- Powder Coated Finish (RAL 9006 White)

**Specifications**

- Height: 3.13 inch
- Width: 3.25 inch
- Length: 46.75 inch (Customer Length Available)
- Weight: 0.121 lbs/in

**Feature**

- Lightweight

**IG-HDC**

---

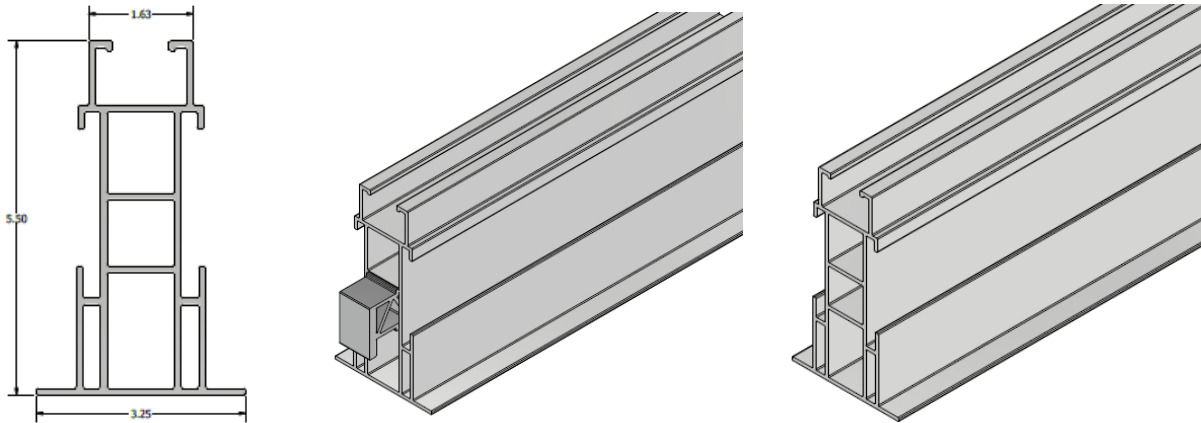

---

**Material:** Aluminum 6005A-T61

**Finish**

- Powder Coated Finish (RAL 9006 White)

**Specifications**

- Height: 5.50 inch
- Width: 3.25 inch
- Length: 46.75 inch (Customer Length Available)
- Weight: 0.226 lbs/in

**Feature/Options**

- Includes Upper and Lower hanger hardware.
- Walkable

**IG-WCA**

---

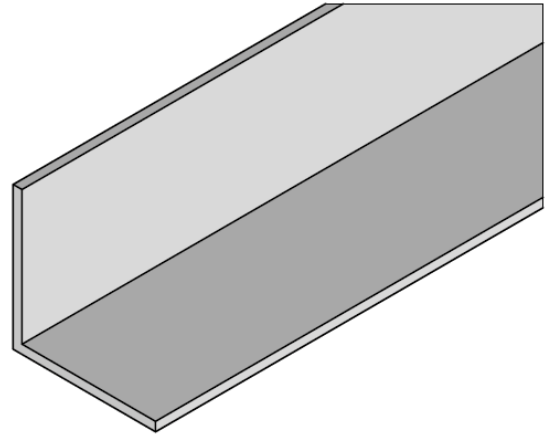
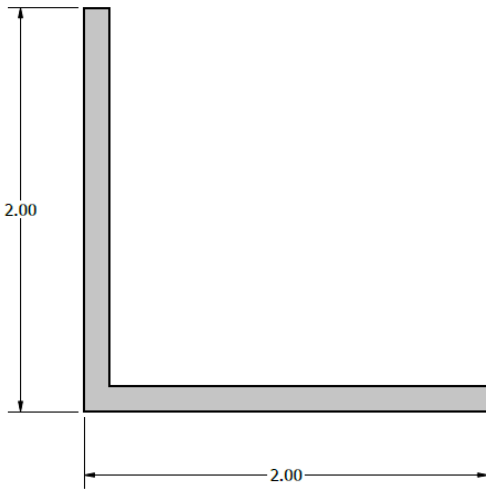

---

**Material:** Aluminum 6005A-T61

**Finish**

- Powder Coated Finish (RAL 9006 White)

**Specifications**

- Height: 2 in
- Width: 2 in
- Supplied Length: 120 in
- Weight: 6.42 lbs/in

**Features/Options**

- N/A

IG-LSC

---

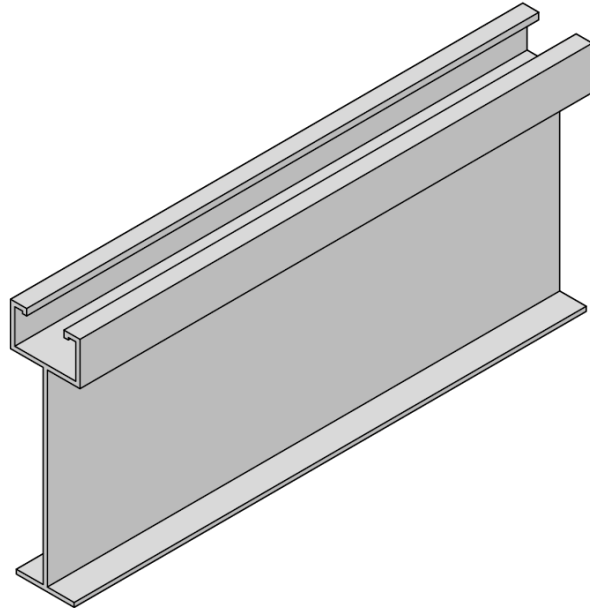
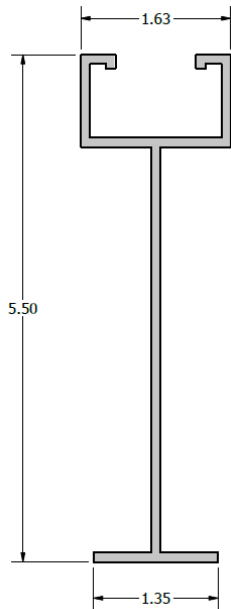

---

**Material:** Aluminum 6005A-T61

**Finish**

- Powder Coated Finish (RAL 9006 White)

**Specifications**

- Height: 5.5 in
- Width: 1.625 in
- Supplied Length: 46.75 in
- Weight 0.098 lbs/in

**Features/Options**

- N/A



**IG-HBK**

---

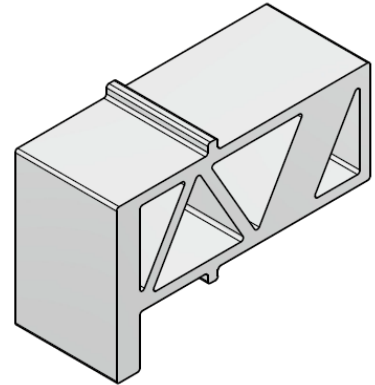
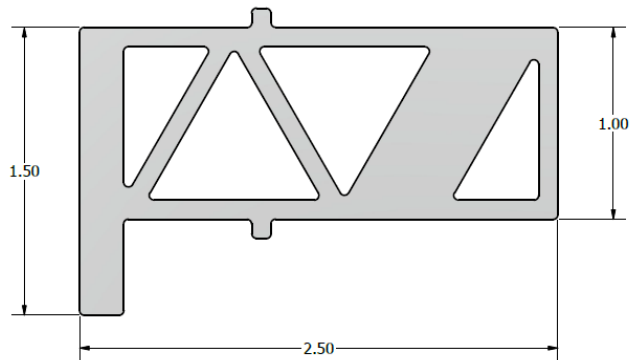

---

**Material:** Aluminum 6005A-T61

**Finish**

- Raw Finish

**Specifications**

- Width: 1.00 inch
- Weight: 0.153 lbs/each

**Feature**

- Indexed for easy installation to proper depth.
- Light weight

**IG-LDC Clip**

---

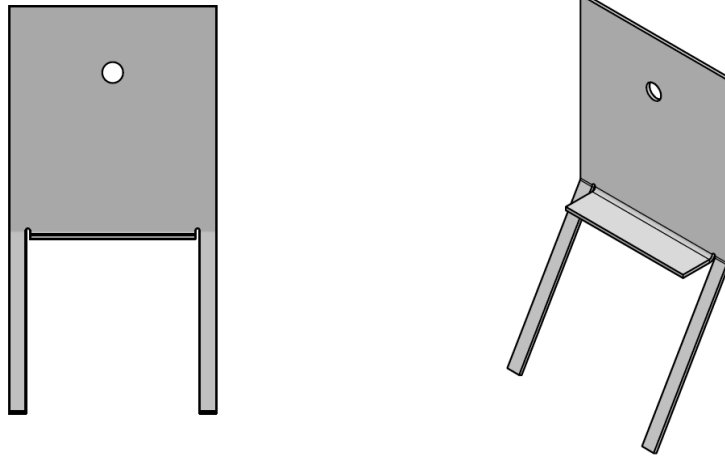

---

**Material:** HDPE KT 10000 UE natural

**Finish**

- Raw Finish

**Specifications**

- Width: 1.25 inch
- Height: 2.5 inch
- Thickness: 0.05 inch

**Feature**

- Indexed for easy installation to proper depth.
- Light weight

## Main and HD Cross Tee Top Connector

---

### IG-MTM-S4

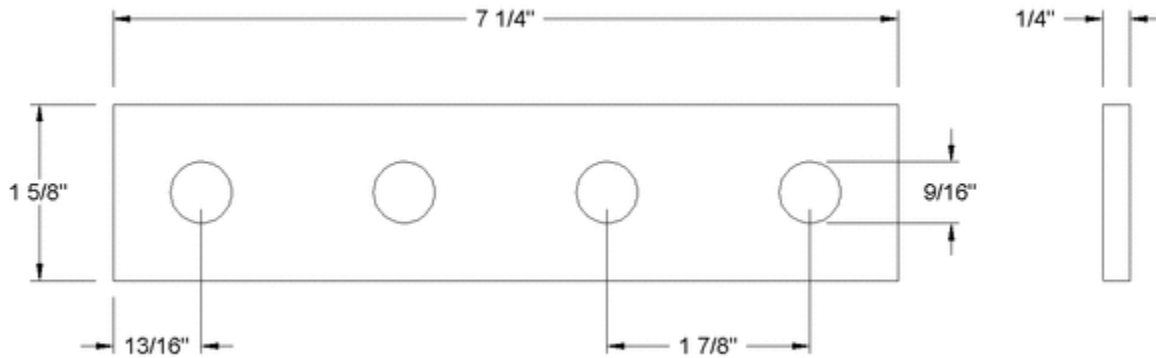

**Thickness:** 0.25 inch

**Finish:** Zinc Plated

**Material:**

---

- Standard- Steel

**Mounting Method:**

---

- Strut nut and bolt with washer
- All the supplied fasteners to be greater than grade 8

**Mounting Location:**

---

- 2 x IG-HDC in perpendicular to IG-M



## Blank Panel (IG-BP-22, BP-24, BP-44)

---

### MATERIALS

- Aluminum Overlay (top)
- Solid HDPE cored
- Adhesive
- Aluminum Overlay (bottom)

### FINISH

- White (standard), other colors available

### ACTUAL DIMENSIONS

- 23.75" x 23.75" (IG-BP22)
- 23.75" x 47.75" (IG-BP24)
- 47.75" x 47.75" (IG-BP44)
- 0.12" Thick

### INSTALLATION METHOD

- Drop in
- Securing clips available

### STANDARDS

- UL-Listed
- Class A fire rated

**\*\* Also Available in 4X4 configuration\*\***

### FABRICATING RECOMMENDATIONS

- Cutting: 72-tooth circular saw with reinforced carborundum or carbide-tipped blade.
- Drilling: High speed drill bit (60° cutting angle, with 12°-15° clearance) or hole saw.

### CLEANING INSTRUCTIONS

- Use a clean, damp, non-abrasive cotton cloth with a mild liquid detergent or household cleaner.
- Rinse with clean water and a clean, non-abrasive cotton cloth.
- Dry panels off with a soft, clean, non-abrasive cotton cloth.
- DO NOT USE: Cleaners with bleach, acid, alkali or sodium hypochlorite. (examples: bleach, drain cleaners, metal cleaners, oven cleaners, rust removers, tub and tile cleaners, lime scale remover)

**\*\*\* NOT A LOAD BEARING PANEL \*\*\***

## LED Flat Panel (IG-LED-22, LED-24, LED-24BU, LED-44)

### 40 Watt 2X4 LED Back Lit Panel

Replaces: Fluorescent Troffer

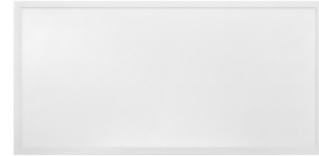

### Models and Specifications

Part Number	Watts	Lumens
MLLG-AL-LED-PANBL-2X4-40-[Color]	40	4528
<b>Replaces</b>	Fluorescent Troffer	
<b>Lumens Per Watt</b>	113	
<b>Voltage</b>	100V-277V	
<b>Frequency</b>	50 / 60 hz	
<b>Life Hours</b>	50,000 (L70) hours	
<b>Color Temp</b>	4000K   5000K	
<b>CRI</b>	80+	
<b>Beam Angle</b>	150°	
<b>Operating Temp</b>	-14°F to +104°F	
<b>Dimmable</b>	1-10V	
<b>Housing</b>	White Aluminum	
<b>Mounting</b>	Recessed   Ceiling-Surface	
<b>Dimensions</b>	23.75 in X 47.75 in X 1.25 in	
<b>Weight</b>	9 lbs	

### Features

- Contemporary design
- Standard 0-10 V dimming
- High luminous efficiency 113 lumens / watt
- Low energy consumption
- UL certified
- Rebate Eligible
- LED lifetime 60 000 hours

### LED-44: 2X LED 2' X 4' and 1X Light Frame

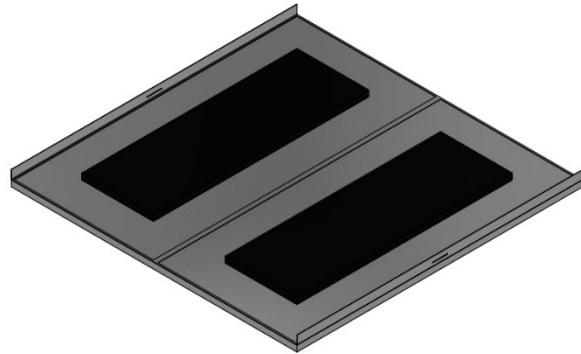
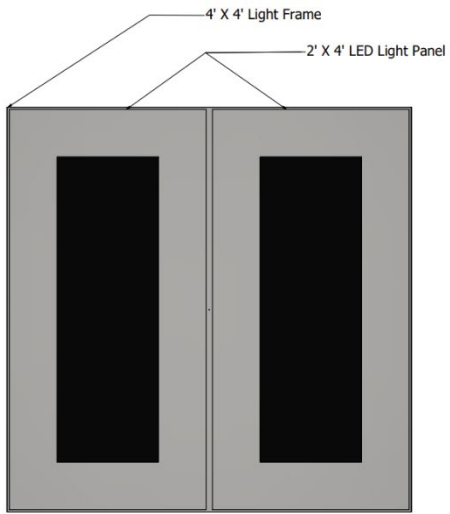

**HEPA Filters (HEPA24, HEPA44)**

---

**Benefits**

- Disposable HEPA module for a variety of cleanroom applications
- Available with 2" and 4" media packs for maximum airflow
- Entire unit is factory sealed and individually scan tested to ensure leak-free performance
- HEPA, ULPA, and SULPA efficiencies available
- Low profile and lightweight for easy installation
- Clear anodized extruded aluminum body



**Performance and Features**

Maximum ducted terminal filter performance in the least expensive configuration, the one-piece aluminum top with integral inlet collar is standard. The frame is clear anodized extruded aluminum and may have either a flat flange for gasket ceilings or an integral knife-edge for gel seal ceilings. Damper options include butterfly or telescoping disc. A center divider with port provides access for damper adjustment. A white painted expanded metal faceguard on the air leaving side provides protection for the media pack. Filters are UL 900 classified.

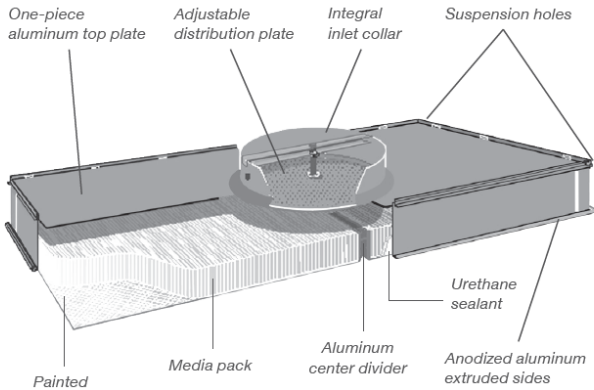

**HEPA and ULPA Filter Media Initial Resistance vs. Filter Face Velocity**

**2" Filters**

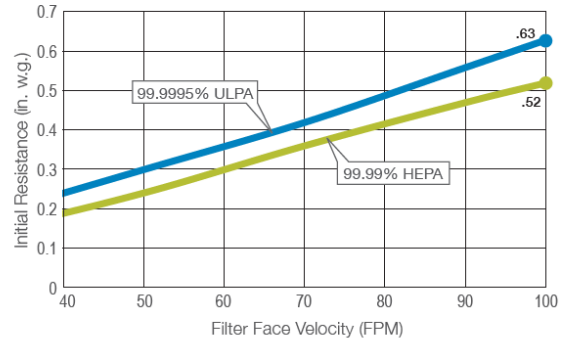

**4" Filters**

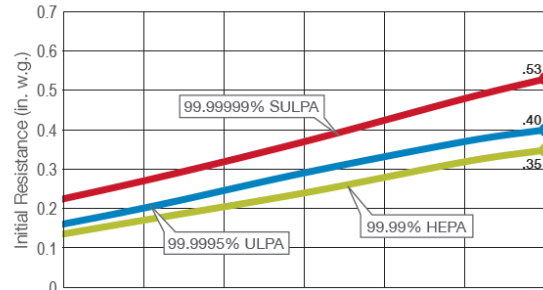

PART NUMBER	A	B	C
NSP-037784	47 5/8	47 5/8	5

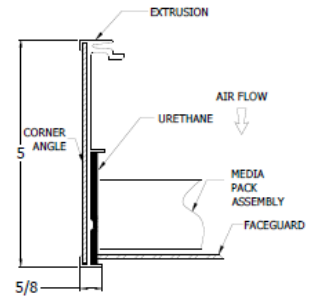
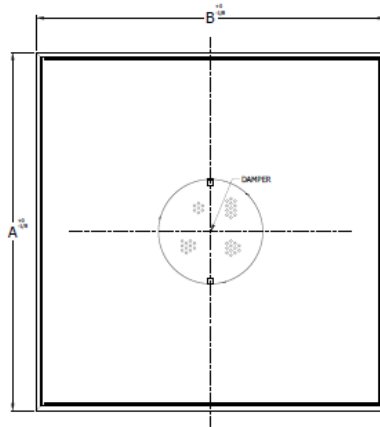
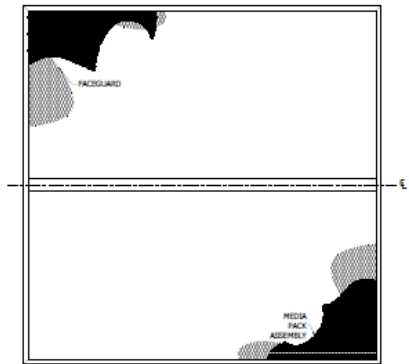
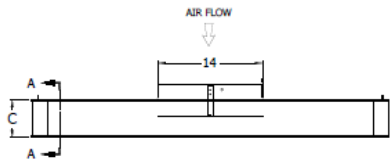

SECTION: A-A

**SPECIFICATIONS:**

FRAME:	EXTRUDED ALUMINUM ALLOY, ANODIZED WITH CENTER DIVIDER
MEDIA:	EXPANDED FLUORORESIN MEMBRANE (EFM)
PACK DEPTH:	50mm
SEPARATOR:	HOTMELT
SEALANT:	POLYURETHANE, TWO-PART, ALL FOUR SIDES
COLLAR SIZE:	1"
DAMPER:	FIXED
GASKET:	NONE
EFFICIENCY:	99.99% ON 0.3 UM, SCAN TESTED
RESISTANCE:	0.26" W.G. MAXIMUM @ 100 FPM
FACEGUARD:	FLATTENED, EXPANDED METAL, WHITE POWDER EPOXY COATING, DOWNSTREAM
NOTE:	NO SILICONE



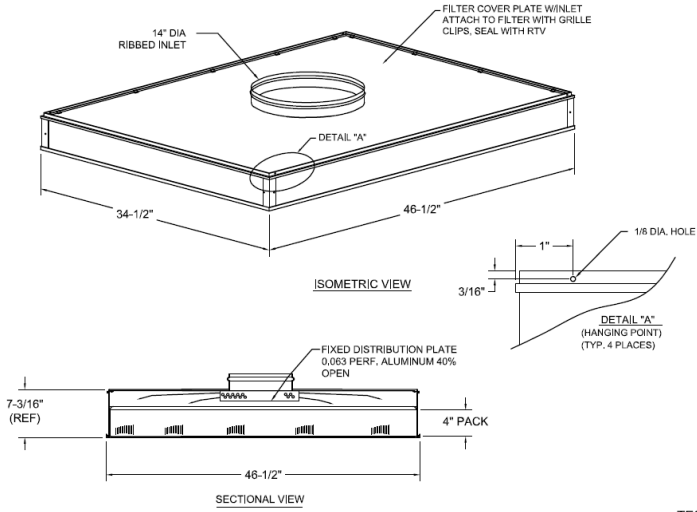

**SPECIFICATIONS**

- COVER PLATE IS CONSTRUCTED OF .050" ALUM.
- CONSTRUCTION: RIVETED AND FASTENED WITH RETAINER CLIPS.
- ALL JOINTS, AND SEAMS TO BE SEALED AIR TIGHT WITH RTV SEALANT.

**FILTER SPECIFICATIONS:**  
 MODEL# AS3G-4-007-NXX14-P0  
 EFFICIENCY: 99.99% @0.3 µm  
 RESISTANCE: 0.35" W.G. @978 CFM  
 OPERATING CONDITIONS: 250°F 100% R.H.

AS3G - ASTROHOOD S3 EXTRUDED ALUMINUM GASKET TEE GRID  
 4 - PACK HEIGHT: 4" DIMPLE-PLEAT  
 007 - FILTER EFFICIENCY: 007 (99.99%) (ME-D0700)  
 N - DAMPER TYPE: NONE  
 XX - HOOD SIZE: 3X4 (34-1/2" X 46-1/2")  
 14 - INLET SIZE: 14" ROUND  
 P - GRILLE: PAINTED EXPANDED CRS  
 0 - INSULATION: NONE  
 Z21038 - SPECIAL SIZE (34-1/2" X 46-1/2")

**TESTING SPECIFICATIONS:**

TEST DETAILS	TEST-RP-CC-001.5	TEST FLOWS
<input type="checkbox"/> DOP	<input type="checkbox"/> Q107	<input type="checkbox"/> TYPE A
<input checked="" type="checkbox"/> PSL	<input checked="" type="checkbox"/> DUAL LASER	<input type="checkbox"/> TYPE B
<input type="checkbox"/> AMBIENT	<input type="checkbox"/> UL-900	<input checked="" type="checkbox"/> TYPE C
<input type="checkbox"/> EMERY 3004	<input type="checkbox"/> UL-596	<input type="checkbox"/> TYPE D
<input type="checkbox"/> OTHER _____	<input type="checkbox"/> OTHER _____	<input type="checkbox"/> TYPE E
		<input checked="" type="checkbox"/> TYPE F
		<input type="checkbox"/> ENCAPSULATED
		<input checked="" type="checkbox"/> 100% FLOW
		<input type="checkbox"/> 20% FLOW
		<input checked="" type="checkbox"/> OTHER 100 FPM FACE

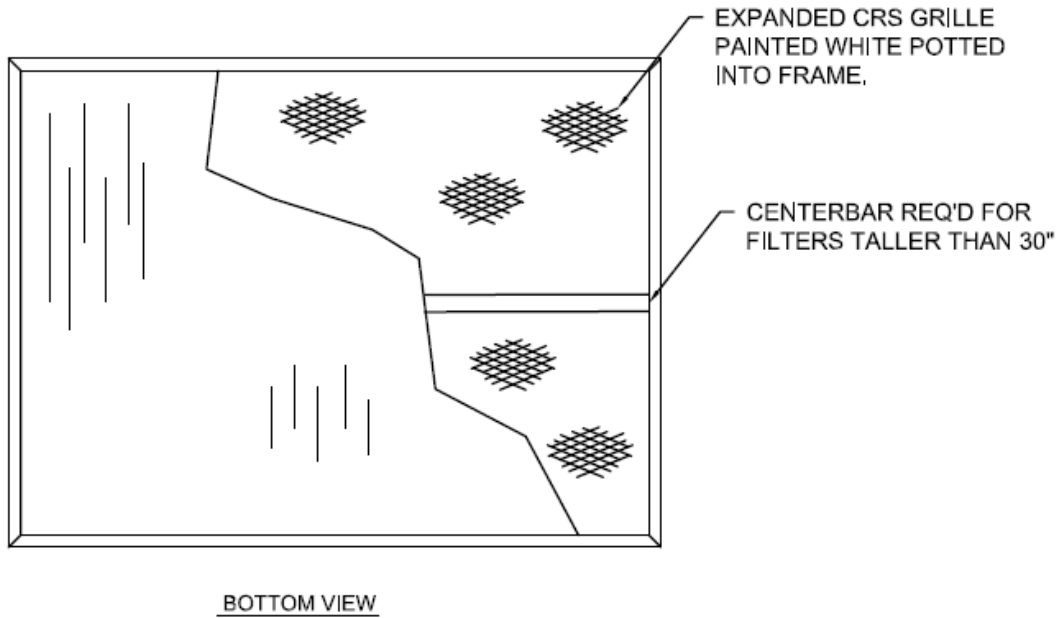

THE WORLD LEADER IN CLEAN AIR SOLUTIONS

# MEGAcel® II eFRM

## MINI-PLEAT HEPA FILTERS



### Benefits

- Available in 99.99% @ 0.3µm, H13 and H14
- Oil Aerosol, Hydrocarbon and High-Humidity Compatible
- Compatible with Photometric Test Method
- Abrasion Resistance 1000X Greater Than Glass
- Designed for Ultra-High Particulate Loading

MEGAcel® II eFRM H13/H14  
Initial Resistance vs. Filter Face Velocity

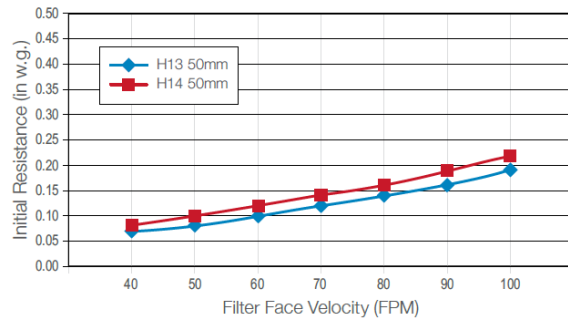

Filter Face Velocity (FPM)	40	50	60	70	80	90	100
H13 50mm (in w.g.)	0.07	0.08	0.10	0.12	0.14	0.16	0.19
H14 50mm (in w.g.)	0.08	0.10	0.12	0.14	0.16	0.19	0.22

### Evolution Meets Revolution

Expanded FluoroResin Media, or eFRM, is the next generation of membrane media technology, designed specifically for applications where oil-based test aerosols (i.e. PAO) are utilized or fine particulate (i.e. Hydrocarbons) are present. This patented HEPA filtration media provides superior mechanical performance at significantly lower energy cost while maintaining the most stringent filtration requirements in these demanding environments.

#### HEPA/ULPA Filter Failure Models

**HANDLING**

- Manufacturing Process
- Transport/Delivery
- Installing

**TESTING & CERTIFICATION**

- Removing/Installing
- Scanning of Filters

**CLEANING**

- Cleaning the Screen
- High Pressure Water

**UNINTENDED CONTACT**

- Moving Equipment
- Repair/Maintenance

HEPA Filters typically fail due to some form of contact combined with the poor mechanical strength of the media.

### Media Resilience Comparison

AAF Flanders' HEPA/ULPA filters utilizing Daikin's ultra-fine fiber membrane media technology are the product of choice in the most demanding environments.

Wet laid glass fiber media is delicate and vulnerable to various levels of degradation, ranging from pinhole leaks to irreparable damage.

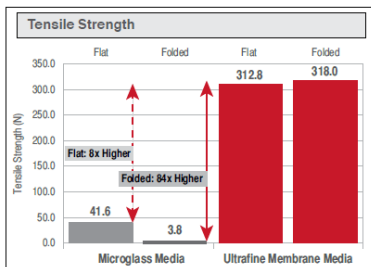
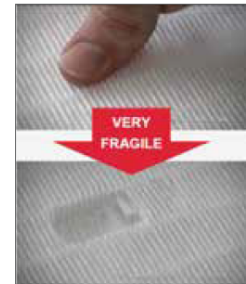

Results based on Test Standard DIN EN 29073-3.

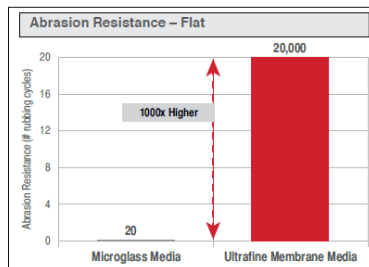

Results based on Test Standard DIN EN 12947-2.

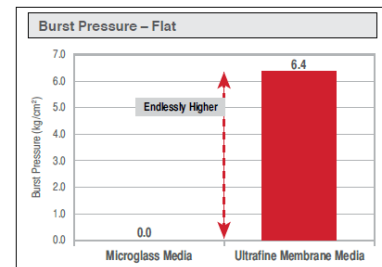

Results based on Test Standard DIN EN 13938-2.



## MEGAcel® II eFRM Filters

### Submittal Options Configuration Nomenclature

**E12A24E B 85 K 2 F 1 S A 0 A**  
 (1) (2) (3) (4) (5) (6a) (6b) (7) (8) (9) (10)

(1) SIZE	(2) MEDIUM	(3) CELL CONSTRUCTION & CONFIGURATION	(4) MEDIUM PACK DEPTH	(5) BOND/ PATCHING	(6a) GASKET MATERIAL	(6b) GASKET LOCATION	(7) ACCEPTANCE LEVEL	(8) FACEGUARD MATERIAL	(9) FACEGUARD LOCATION	(10) CENTER DIVIDER			
<b>(1) Size:</b> Designates Imperial Measurement Filter Height in Whole Numbers Filter Height in Additional Fractions of an Inch (see chart below) Filter Width in Additional Fractions of an Inch (see chart below) Filter Width in Whole Numbers Fractional Notation for Imperial Sizes: A = 0    B = 1/8    C = 1/4    D = 3/8 E = 1/2    F = 5/8    G = 3/4    H = 7/8 J = 1/16    K = 3/16    L = 5/16    M = 7/16 N = 9/16    P = 11/16    Q = 13/16    R = 15/16 <b>Example: E23D35H</b> 23 3/8 High x 35 7/8 Wide		<b>(2) Media:</b> B – eFRM PAO Compatible		<b>(3) Cell Construction:</b> 85 – ‘C’ Channel (2-7/8 Depth, Fluid Seal) 87 – 3/4” Knife-Edge (3-1/4” Depth) 89 – ‘C’ Channel (2-3/4” Depth) 99 – Special Configuration		<b>(4) Pack Depth:</b> K – 50mm, Hotmelt Bead Separator		<b>(5) Patching:</b> 2 – PU Bond – Silicone Patching per IEST-RP-CC001 4 – PU Bond – Non-Silicone Patching per IEST-RP-CC001 6 – PU Bond – No Patching Allowed		<b>(6a) Gasket/Gel Material:</b> B – Polyurethane Gel    T – Neoprene F – Silicone Gel    Y – Silicone P – None    Z – Special    *Gaskets are 1/4” thick and 3/4” wide.		<b>(6b) Gasket/Gel Location:</b> 0 – None    3 – Both Faces 1 – Air Entering Side    4 – Special 2 – Air Leaving Side    *85 Cell Construction requires gasket location of 1.	
<b>(7) Acceptance Level:</b> H – 99.99% Scan Tested S – 99.99% @ 0.3µm, Cold PAO Hand Scan		<b>(8) Faceguard Material:</b> A – None    D – Perf 304 SST B – White Painted Exp Steel    E – Perf Anodized Alum C – Exp 304 SST    Z – Special		<b>(9) Faceguard Location:</b> 0 – None    3 – Both Sides 1 – Air Entering Side    9 – Special 2 – Air Leaving Side		<b>(10) Center Divider:</b> A – None    D – Center Divider, 2 Test Ports B – Center Divider    Z – Special C – Center Divider, 1 Test Port							

### MEGAcel® II eFRM Specifications

#### 1.0 General

1.1 Air Filters shall be HEPA grade air filters with eFRM (FlouroResin Media) technology, hotmelt bead separator, extruded anodized aluminum frame, urethane sealant, and either polydimethylsiloxane fluid seal or dry gasket seal.

1.2 Sizes shall be noted on drawings and/or other supporting materials.

#### 2.0 Construction

2.1 Filter media shall be of continuously pleated eFRM, expanded FlouroResin Media; no glass allowed.

2.2 eFRM media shall be compatible with industry standard validation and testing methodologies using an acceptable oil aerosol agent (i.e. PAO).

2.3 The media pack shall be affixed permanently to the filter frame assembly by means of a polyurethane sealant.

2.4 The filter frame shall be of anodized extruded aluminum and shall be designed for use in Gasket Seal or Fluid Seal systems.

2.5 Gasket system filters shall be factory installed 1/4” thick by 3/4” wide, closed cell neoprene affixed to the sealing surface. Filter Frame sealing surface to have a flatness tolerance of +/- 1/32”

2.6 Fluid Seal system filters shall have:

2.6.1 A continuous trough around the perimeter of the filter with continuous, integral indication of acceptable fluid seal fill level. The fluid seal trough shall be filled at the factory.

2.6.2 Fluid seal material shall be characterized for all salient mechanical, physical,

and chemical properties such as Hardness/Penetration, Tack, and Migration of free silicone.

2.6.3 Fluid seal material shall be characterized for chemical resistance to known industry accepted decontamination agents, cleaning agents, and filter testing reagents.

2.6.4 Fluid seal material shall be tested for chemical compatibility to all materials in contact during manufacturing including gloves, tools, mixing equipment, dispensing equipment, and packaging materials, as well as potential airborne contaminants & poisons.

2.6.5 Fluid seal material shall demonstrate resistance to accelerated life cycle testing.

2.6.6 Fluid Seal shall withstand knife edge insertion to partial depth without complete depth cutting or full length splitting.

#### 3.0 Performance

3.1 The filter shall have a tested efficiency of (99.99% or 99.995% @ 0.3µm or 99.95% or 99.995% @ MPPS) when tested under the guidance of either IEST-RP-CC001 or EN1822.

3.2 Each Filter shall be tested for initial (clean) pressure drop at rated flow. Initial resistance not to exceed 0.25” w.c. at rated flow.

3.3 Each Filter shall be factory scanned in accordance with IEST-RP-CC034 or EN1822.

3.4 Filter shall be listed by Underwriters Laboratories as UL 900.

## Additional Hardware- Hanger assembly

---

### Steel Channel Spring Strut Nut



**Thickness:** 3/8"

**Thread Size:** 3/8" – 16

**Width:** 1-3/8"

**Depth:** 53/64"

**Material:** Steel

**Finish:** Electro Galvanized

**Color:** Silver

### 3/8 Threaded Rod



**Thread Type:** UNC

**Thread Size:** 3/8" – 16

**Tensile Strength:** 150,000 psi

**Length:** Cut to Length

**Thread Direction:** Right Hand

**Material:** Steel w/ Zinc Yellow Chromate Finish

**Features:** Wrench Flat Available

### Turnbuckle



**Thread Size:** 3/8" - 16

**Length:** 7-1/8"

**Material:** 1045 Carbon Steel

**Finish:** Hot Dipped

**Rated Capacity:** 1200 lbs.

**Specification:** ASTM F 1145-92,  
FF-T-791b Type 1, Form 1-Class 2

**Square Washer**

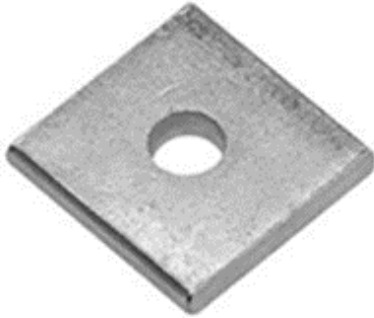

**Thickness:** 3/8"

**Length:** 1"

**Width:** 1"

**Material:** Steel

**Finish:** Electro Galvanized

**Color:** Silver

**3/8" Round Washer**



**Size:** 3/8"

**Diameter:** 1"

**Material:** Steel

**Finish:** Electro Galvanized

**Color:** Silver

**LH/RH Stud**



**Thread Type:** UNC

**Thread Size:** 3/8" – 16

**Tensile Strength:** 150,000 psi

**Length:** 6"

**Thread Direction:** Left Hand/ Right Hand

**Material:** Steel w/ Black Oxide Finish

**Features:** Wrench Flat Available

**Hex Nut**



**Thread Type:** UNC

**Thread Size:** 3/8" – 16

**Thickness:** 21/64"

**Width:** 9/16"

**Material:** Steel w/ Zinc Plate Finish

**Features:** ASTM F594

**McMaster P/N:** 92673A125

**3/8" Nylon Locknut**



**Thread Type:** UNC

**Thread Size:** 3/8" – 16

**Thickness:** 29/64"

**Width:** 9/16"

**Material:** Steel w/ Zinc Plate Finish

**McMaster P/N:** 95615A140

**AHA-3/8-IG-PP-TB**

---

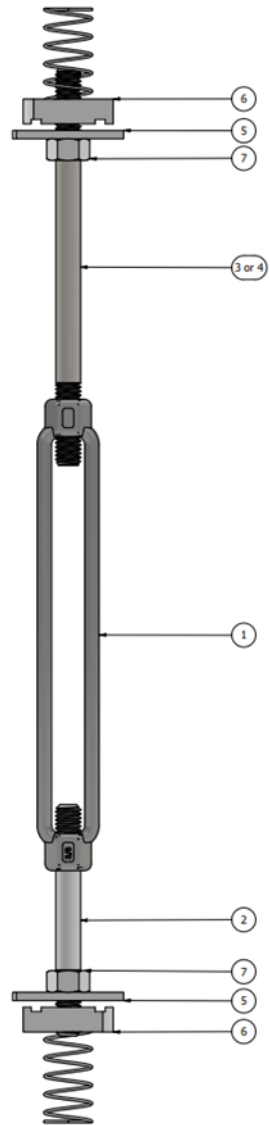

Item No	Quantity	Part Number	Description
1.	1	Turnbuckle	Main to Main Corner Splice Plate
2.	1	LH/RH Stud	LH/RH Threaded Stud
3.	1	LH/RH Stud	LH/RH Threaded Stud
4.	1	Threaded Rod	Threaded Rod Cut to Length
5.	1	Square Washer	1in x 1in Square Washer
6.	2	Spring Nut	Spring Nut
7.	2	3/8"-16 Hex Nut	Hex Nut