

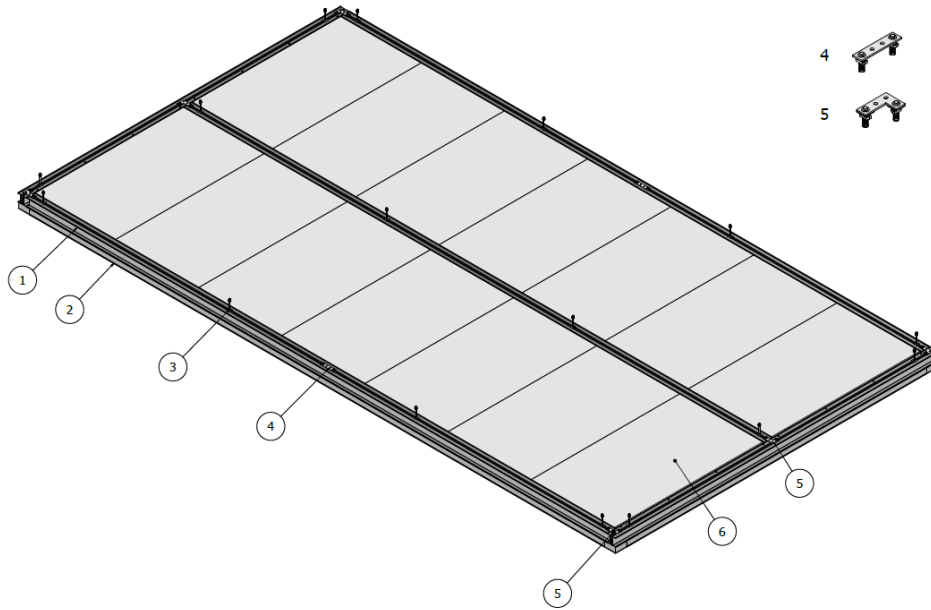

## Typical Perfect Plenum Cap Configuration



### Parts List

Item No.	Part Number	Description
1	PP-M-20	Perfect Plenum Main – 20ft
2	PP-HT-20	Perfect Plenum Head Track – 20ft
3	AHA-3/8-PP-SS	Airtho Hanging Assembly – 3/8" – Perfect Plenum to Steel
4	PP-MTM-S	Connecting Plate – Main to Main Straight
5	PP-MTM-C	Connecting Plate – Main to Main Corner
6	PP-IMP	Perfect Plenum Modular IMP



PP-M

---

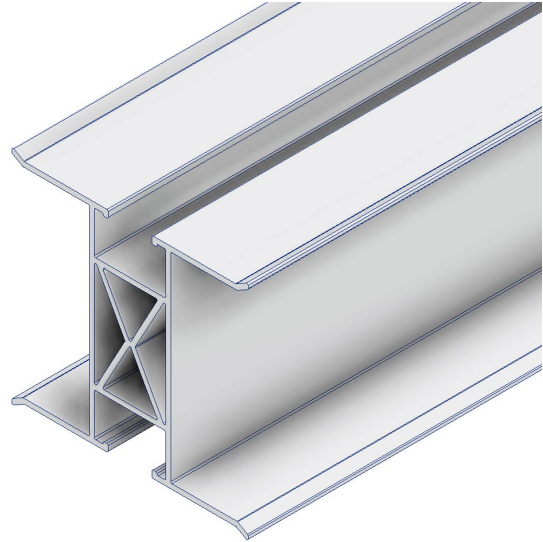
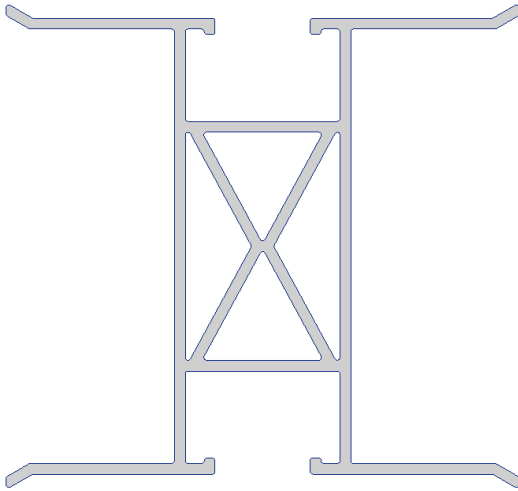

**Material:** Aluminum 6005A

**Finish**

- Mill Finish (-M, End of Part Number)

**Specifications**

- Height: 4.5 in
- Width: 4.7 in
- Supplied Length: 240 in
- Weight: 0.24 lbs/in

**Features**

- Sealant pocket for complete seal
- Integrated strut channel for attaching accessories and hanging Intelligrid

**Rated Capacity**

- 800 lbs. per strut nut location for light duty hanger
- 1200 lbs. per strut nut location for heavy duty hanger
- For system capacity refer to applicable project drawings.



## PP-HT

---

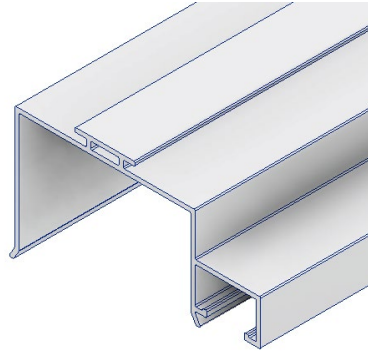
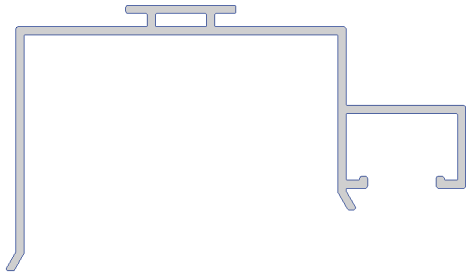

**Material:** Aluminum 6005A

### Finish

- Mill Finish (-M, End of Part Number)

### Specifications

- Height: 3.37 in
- Width: 6.00 in
- Supplied Length: 240 in
- Weight: 0.146 lbs/in

### Features

- Sealant pocket for complete seal
- Integrated strut channel for attaching accessories and hanging Intelligrid
- Only used with PP-M (See Picture Below)

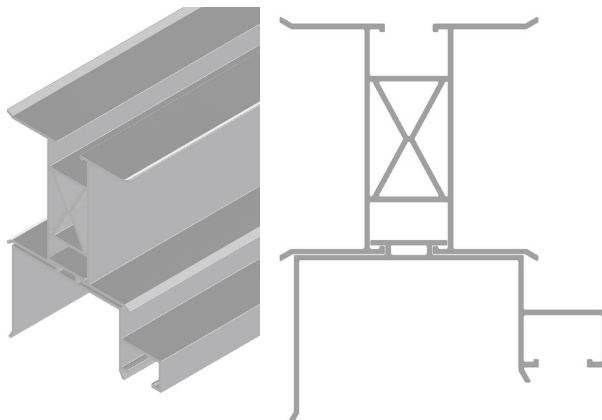



## Typical Plenum Assembly Detail

---

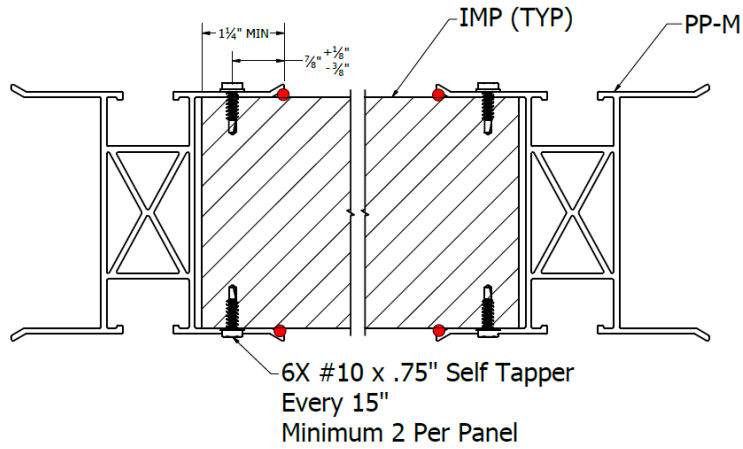

**PP-M Assembly Side View**

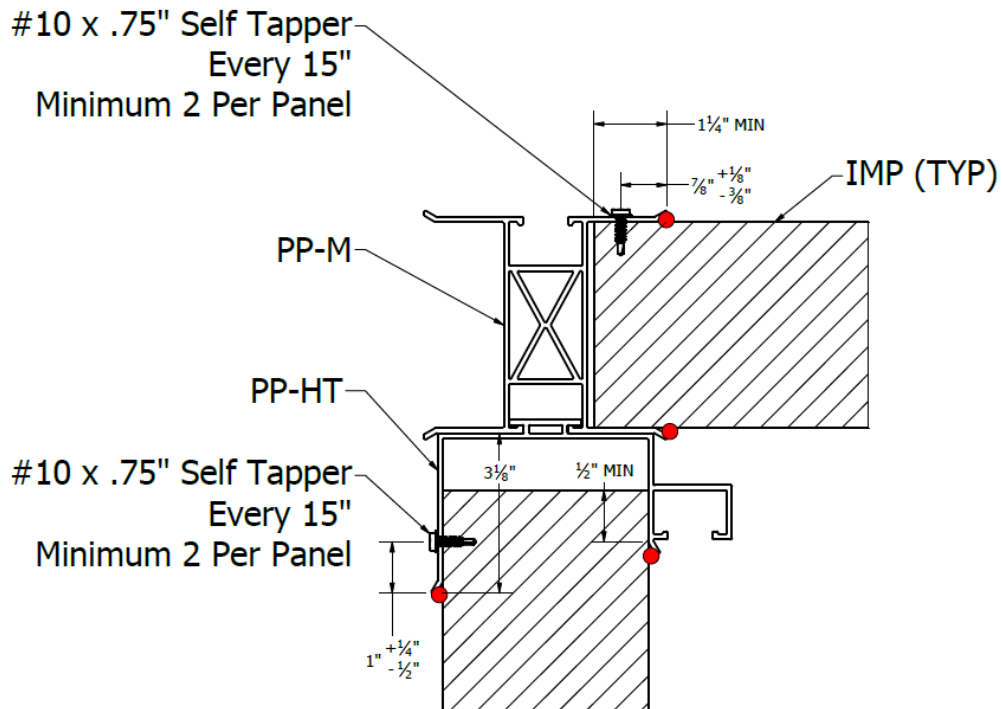

**PP-M and PP-HT Assembly Side View**



## Main Top and Bottom Connector

---

### PP-MTM-S

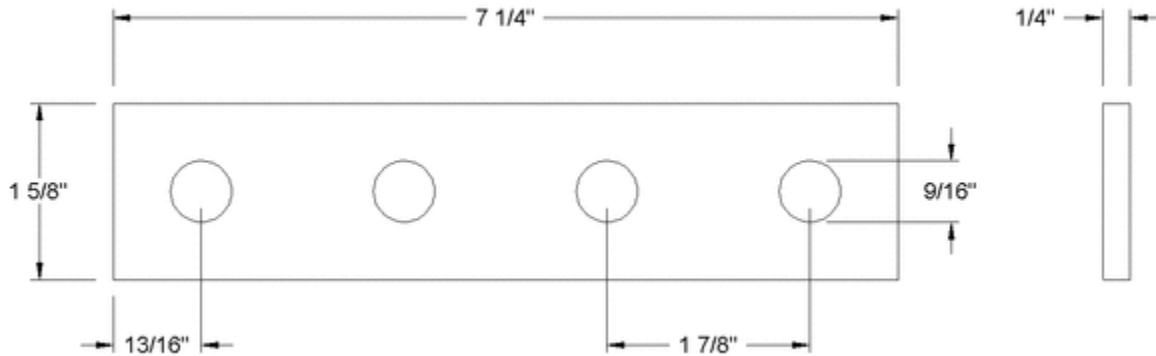

**Thickness:** 0.25 inch

**Finish:** Zinc Plated

**Material:**

---

- Standard- Steel

**Mounting Method:**

---

- Strut nut and bolt with washer
- All the supplied fasteners to be equal to or greater than Grade 8

**Mounting Location:**

---

- PP-M to PP-M colinear connection



## Main Top and Bottom Corner Connector

---

### PP-MTM-C

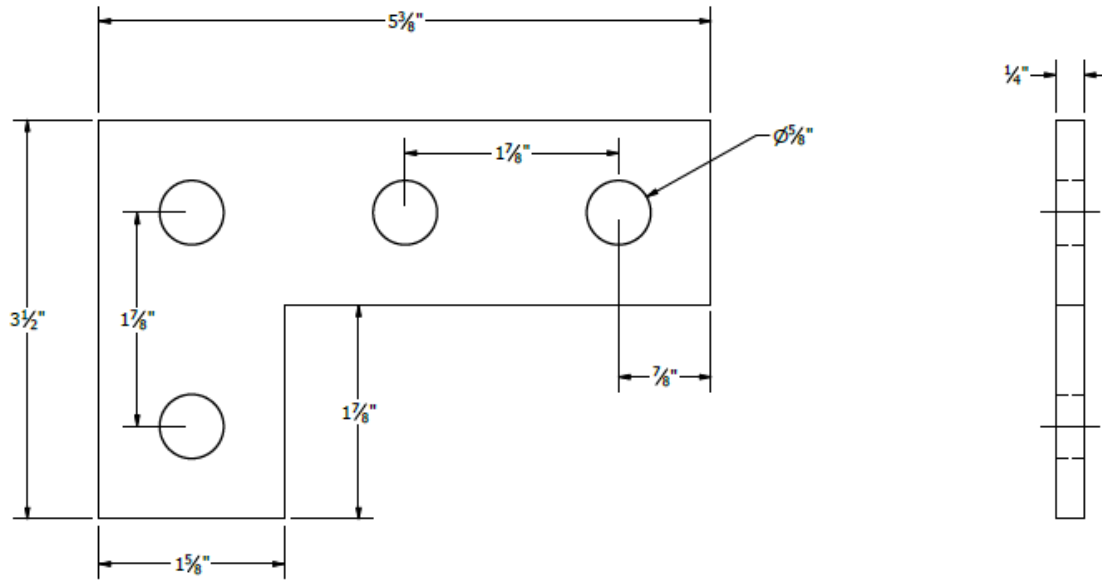

**Thickness:** 0.25 inch

**Finish:** Zinc Plated

**Material:**

---

- Standard- Steel

**Mounting Method:**

---

- Strut nut and bolt with washer
- All the supplied fasteners to be equal to or greater than Grade 8

**Mounting Location:**

---

- PP-M to PP-M corner connections or PP-M to PP-M perpendicular connections



## Additional Hardware- Hanger assembly

---

### Steel Channel Spring Strut Nut



**Thickness:** 3/8"

**Thread Size:** 3/8" – 16

**Width:** 1-3/8"

**Depth:** 53/64"

**Material:** Steel

**Finish:** Electro Galvanized

**Color:** Silver

### 3/8 Threaded Rod



**Thread Type:** UNC

**Thread Size:** 3/8" – 16

**Tensile Strength:** 150,000 psi

**Length:** Cut to Length

**Thread Direction:** Right Hand

**Material:** Steel w/ Zinc Yellow Chromate Finish

**Features:** Wrench Flat Available

### Turnbuckle



**Thread Size:** 3/8" - 16

**Length:** 7-1/8"

**Material:** 1045 Carbon Steel

**Finish:** Hot Dipped

**Rated Capacity:** 1200 lbs.

**Specification:** ASTM F 1145-92,  
FF-T-791b Type 1, Form 1-Class 2



### Square Washer

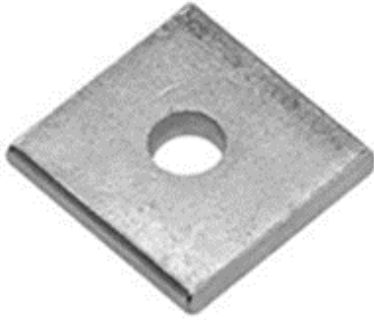

**Thickness:** 3/8"

**Length:** 1"

**Width:** 1"

**Material:** Steel

**Finish:** Electro Galvanized

**Color:** Silver

### 3/8" Round Washer



**Size:** 3/8"

**Diameter:** 1"

**Material:** Steel

**Finish:** Electro Galvanized

**Color:** Silver

### LH/RH Stud



**Thread Type:** UNC

**Thread Size:** 3/8" – 16

**Tensile Strength:** 150,000 psi

**Length:** 6"

**Thread Direction:** Left Hand/ Right Hand

**Material:** Steel w/ Black Oxide Finish

**Features:** Wrench Flat Available





**Hex Nut**



**Thread Type:** UNC

**Thread Size:** 3/8" – 16

**Thickness:** 21/64"

**Width:** 9/16"

**Material:** Steel w/ Zinc Plate Finish

**Features:** ASTM F594

**McMaster P/N:** 92673A125

**3/8" Round Washer**



**Thread Type:** UNC

**Thread Size:** 3/8" – 16

**Thickness:** 29/64"

**Width:** 9/16"

**Material:** Steel w/ Zinc Plate Finish

**McMaster P/N:** 95615A140